

NAKED

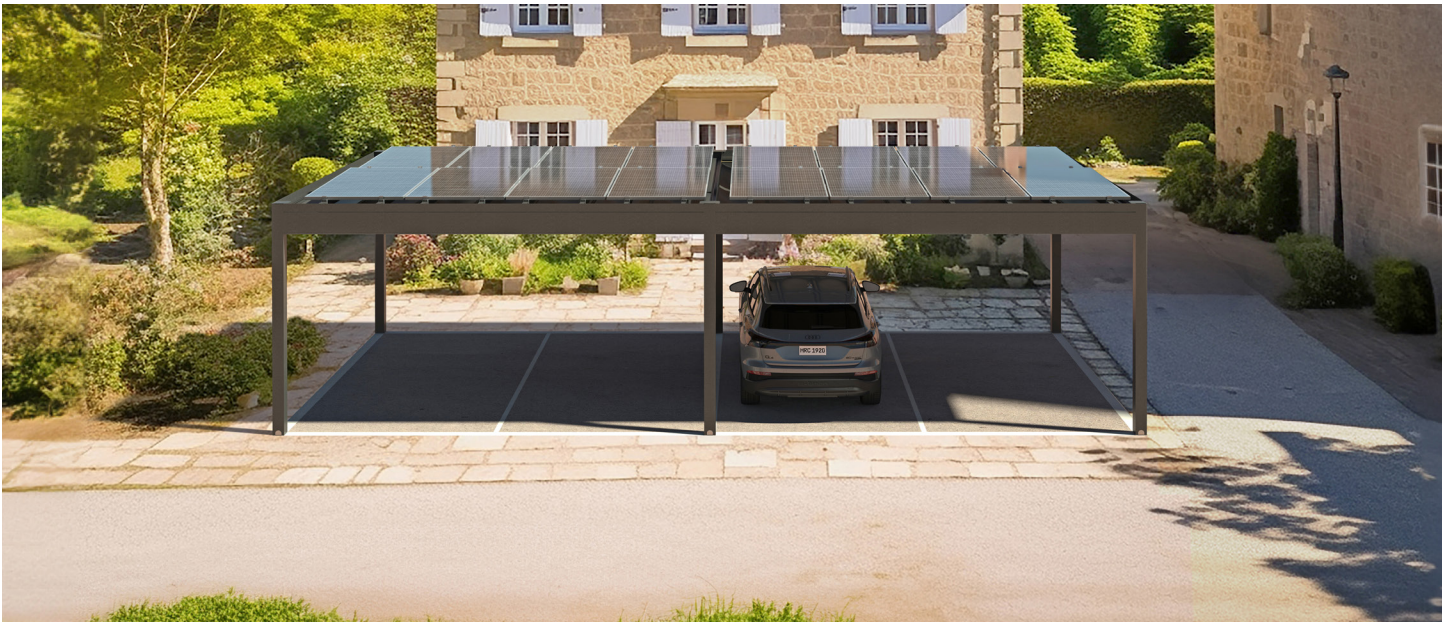



shelteroutdoor.com | 855.768.4450



TM

The Standard Unit Naked

The Naked Pergola is a support structure for solar panels, with additional options for a typical shading structure. Eliminating the need for auxillary structures to incorporate solar power into your landscape design.



LED Lighting

LED strip lighting can be integrated into the perimeter of the roof structure. Controlled by a remote and available in natural white 4200K 24V 13W/M, and RGB 24V 10W/M.

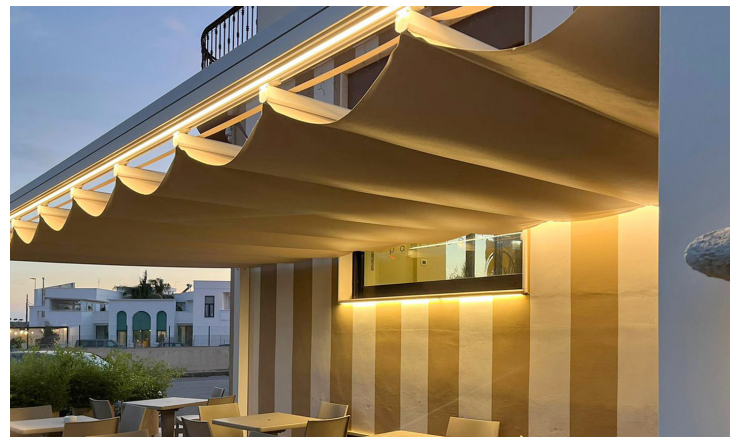

Screens

Integrated screens are available in two options.

- Motorized Zip Screens
- Manual VOK Screens



Soltis 96

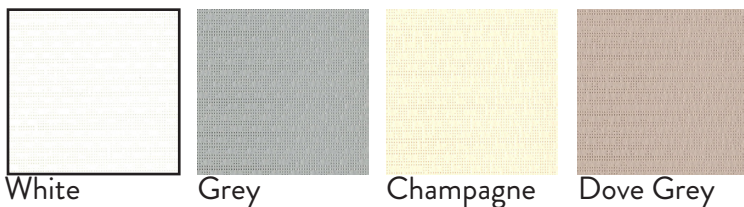

502 Satin (Motorized Only)



Standard Color Options

Powder Coated Aluminum has a strong UV Resistance, does not contain solvents or VOCs, and resists against scratches, corrosion, and chipping. Available in 4 standard colors Dark Brown, Dove Grey, Special Grey, and White



Dark Brown



Dove Grey



Special Grey

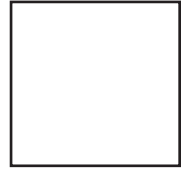

White

Custom Color Options

Custom RAL Powder Coats are available for both the frame so that you can match existing architecture or personal taste. From matching a sage green, pale blue, or specific gray color there are over 500 color options to choose from.



Cabana up Color Options

The manually operated roman roof shade is locked in to place with magnet sockets. This roof shade is made of PVC sheets that allow for east maintance. These sheets are available in 4 types of materials.

Matt Blackout 602



White



Grey



Champagne



Dove Grey

Mounting Options

Externall Mount

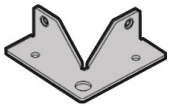

Visible from the outside of the post, this mount provides direct anchorage to an existing slab.

Wall Mount

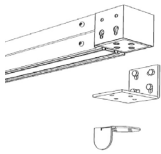

This wall mount provides a L- Shape bracket to replace where the upright post would support the structure.

Internal Mount

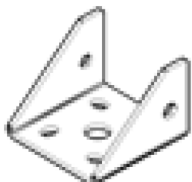

Concealed inside the post, this mount provides direct anchorage to an existing slab.



Multiple Configuration Options

Multiple Configuration Options (roof only and wall mount options also available)

Single Roof 4 Post Max Dimension: 19'-8" W X 16'-4" L X 8'-3"H

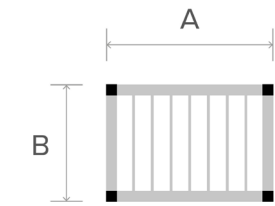

Freestanding

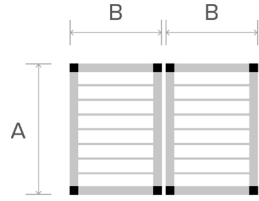

Modularity on Side A

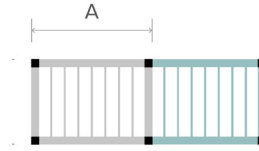

Coupled on Side B

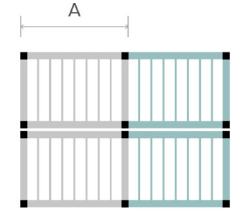

2 Coupled Modules
Modularity Connected
on Side A

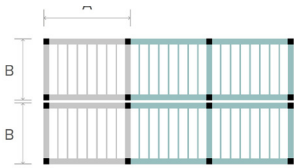

Multimodularity Coupled
Modules

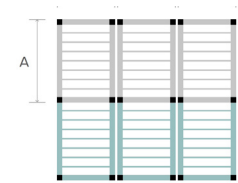

Multimodularity Coupled
Modules

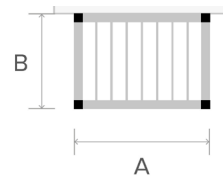

Wall Mounted options
available with all
configurations

Third Party Solar Panels Clamp Kit

For third party solar panels it will be up to the designer to determine the type of system, the number of panels and their arrangement while respecting the dimensional limits of the structure. Individual purlins and individual panel clamp kits are available for calculating the total mounting.

For each panel with the long side parallel to the purlins, 2 clamp kits are needed.

For each panel with the short side parallel to the purlins, 3 clamp kits are needed.

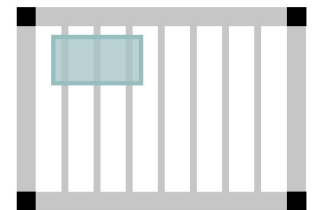
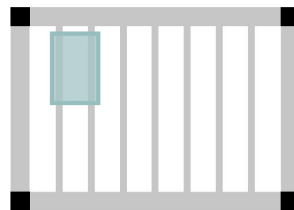

Solar Panel Kit

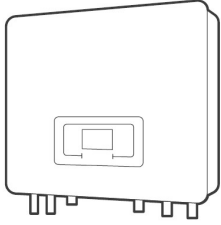

HYBRID PHOTOVOLTAIC INVERTER with integrated battery manager

- Rated power 4 kW
- Typical DC power 6 kW
- Zero grid emission function
- Integrated back-up function
- Integrated energy master
- Smart control System
- RS485, USB communication interface
- Graphic display
- IP 65 degree protection
- Integrated DC disconnect switch
- Counterparts and mounting accessories included
- Weight 22,5 kg
- Dimensions (H*W*D) 482mm*503mm*183mm
- 10 years warranty

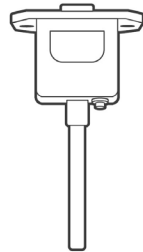
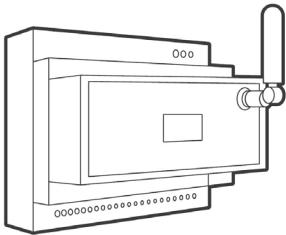

4G EXTERNAL INVERTER KIT FOR REMOTE CONTROL

- 4G kit for single-phase inverters Lite series Hybrid and three-phase inverters
- Mobile network data traffic prepaid for 10 years
- Integrated antenna
- Software APP for main acces free to monitoring platform included
- Weight 300 g
- Dimensions (H*W*D) 89mm*105mm*65mm
- 10 years warranty

N° 10 PHOTOVOLTAIC PANELS

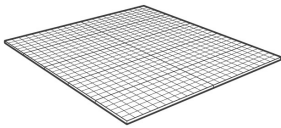

- 132 cells half cut BBO 500-510 Wp
- 85% linear power output warranty until the end of the 25th calendar year
- Power output the first year of operation 97%
- Weight 26 kg
- Dimensions (H*W*S) 2.094mm*1.134mm*35mm
- 15 years warranty

Optional

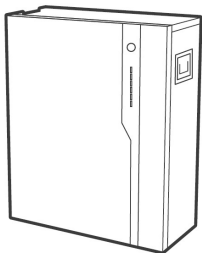

N° 10 PHOTOVOLTAIC PANELS

- Lithium iron phosphate technology battery pack
- Cables interconnecting with inverter
- Accessories for connection to panel
- Weight 54 kg
- Dimensions (H*W*D) 600mm*480mm*211.5mm
- 10 years warranty

